

## Section 12

# Chassis Equipment

*Jockey Wheels & Stands*

*U Bolts*

*Jockey Wheel Receivers*

*Brake Kits*

*Bearings*

*Axles*

*Springs*

*Adjustable Legs*

*Permanent Fixed Steps*

*Ladders*

*Jerry Can Holders*

*Jerry Cans*

*Spare Wheel Mounts*

*Couplings*

# SAFETY 800

**EXCLUSIVE Trailer Tongue Weight Jockey Wheel**

**ITS A JOCKEY WHEEL, ITS A SCALE  
ITS A TRAILERING SOLUTION**

800lb. jockey wheel  
Safe and simple to operate  
Measures tongue weight between 200 and 800lbs  
Lock and Go Collar



Safety 800 - 9005

### Do you know your tongue weight?

Australian RV accessories proudly presents an industry first with the ALL - IN - ONE Safety 800 Trailer tongue Weight Jockey wheel. This is the only device on the market today that instantly tells your trailer load is properly balanced for safe, efficient a proper towing. Come out of trailerings dark days and see the light with the all new Safety 800!

## AL-KO

### 6" Jockey Wheel



265mm standard wheel  
400kg max static load capacity  
150mm solid rubber wheel  
Zinc plated  
Adjustable height: min: 507mm, Max: 772mm, Extension:

Jockey Wheel - 6"- 9010

## AL-KO

### Jockey Wheel 6" Swing Up



Jockey wheel with 150mm (6") standard wheel and locking swivel U-bolt bracket.

Jockey Wheel - 6" Swing Up - 9012

### 3/4" Master Cylinder



Hydraulic. Used on single axle trailers, 3/4 inch Hydraulic Master Cylinders are an integral part of the brake system. 3/4 inch is the bore size.

3/4" Master Cylinder - 9015

## AL-KO

### Power Mover with Solid Wheel



With solid wheel. Ideal for caravans. The power wheel is a very efficient way of moving your caravan or boat around. It lifts to a height of 840mm. Best on the market.

#### OPERATING INSTRUCTIONS

7 Easy steps to moving your Caravan or Trailer



1. Engage caravan/trailer park brake or chock wheels on the downhill side.
2. Secure the AL-KO Power Mover to your caravan/trailer drawbar.
3. Lower the Power Mover to the painted line on the telescopic tube.
4. Select Directional Settings on the two pawls (see instructions below).
5. Fill or engage the Power Mover traction handle.
6. Carefully release the caravan/trailer park brake.
7. Raise and lower the traction handle for controlled easy movement.

#### CHOOSING THE DIRECTION SETTINGS



The AL-KO Power Mover is equipped with two directional pawls.

With the Power Mover securely fixed to the trailer or caravan drawbar move both of the spring loaded pawls (1) and (2) in the direction you wish the trailer to move. This should be done before any effort is applied to the traction handle.

Ensure the Power Mover is lowered to the painted ring (3) around the tank of the unit as under heavy loads and extended height, damage may occur to the telescopic tube of the Power Mover.

## AL-KO

QUALITY FOR LIFE

Power Mover - 9019

### 12 Volt Motorized Power Wheel

**RATED 2268KG LOAD**



#### FEATURES:

- Button Controlled Handle for easy trailer manoeuvring
- Automatic Brake Function-quickly attaches to most trailer tongues
- Heavy-Duty 8" Solid Rubber Wheel Trouble-free rust resistant powder coat finish
- Forward and Reverse

#### SPECIFICATIONS:

12V DC Battery Drive  
Max Jack Load: 600lb / 272kg

12 Volt Motorised Power Wheel - 9020



**Trail-A-Mate**



Hydraulic jockey wheel that converts in to a jack when you need it. You simply swap the wheel for a solid base plate

- Capability - WLL 1,000kg / ATM 2,900kg
- Versatility - Easily converts from a jockey wheel to a jack
- Ease of Use - Being hydraulic it takes very little effort to operate
- Safety - Fully complies with the Australian mandatory safety standards (2693:2007)

Trail-A-Mate - 9026  
**8" Jockey Wheel**



**Trail-A-Mate II**

Trail-A-Mate MkII is a hydraulic caravan jack designed to lift larger and heavier caravans than our original Trail-A-Mate Jockey Wheel Jack

- Capability - WLL 1,500kg / ATM 3,500kg
- Ease of Use - Being hydraulic it takes very little effort to operate
- Safety - Fully complies with the Australian mandatory safety standards (2693:2007)

Trail-A-Mate II - 9027  
60mm Bracket - 9028



**Trail-A-Mate Sidewinder**

For stress free raising and lowering of caravans and trailers. Sidewinding jockey wheel will double as both a jockey wheel and a caravan jack for caravans up to 16' and a max GTM of 1600kgs.

Trail-A-Mate Sidewinder - 9065



Jockey wheel with 200mm (8") steel rimmed rubber wheel.

Jockey Wheel - 8" - 9030



**Jockey Stands**

Jockey Stand side winder, with locking swivel U-bolt bracket. 350kg load capacity - extension 250mm

Jockey Stands Weld On - 9042  
Jockey Wheel Stand - Swing Up - 9060



**8" Jockey Wheel- Swing Up**

3 bolt locking pin swivel bracket  
Zinc plated  
400kg capacity

Jockey Wheel - 8" Swing Up - 9035



**Jockey Wheel - 10"**

Jockey wheel with 255mm (10") pneumatic wheel.

With solid wheel - 9048



**Dual Power Wheel**

This is the ultimate power wheel. Ideally suited for large vans and boats. Superior in traction and strength, this model is used for large caravans and boats where inclines are

With solid wheel - 9038



**Jockey Wheel - 10" Swing Up**

400kg max static load capacity  
With 3 bolt swivel bracket & handle  
250mm metal wheel with solid tyre  
Zinc plated  
Adjustable height: min: 630mm, Max: 880mm, Extension: 250mm

With solid wheel - 9052



**EZIMOVER Swing Up Jockey Wheel**

Heavy Duty: 350kg Load Capacity.  
Capable of manoeuvring up to 2 tonne caravan, horse float or trailer on an even surface with minimum effort

EZIMOVER Swing Up Jockey Wheel - 9057

**EZIMOVER Swing Up Jockey Wheel - Dual Wheel**

Heavy Duty: 350kg Load Capacity.



EZIMOVER Swing Up Jockey Wheel - Dual Wheel - 9058

**Side Winding Swivel Jockey Wheel - 6" Side Winding**

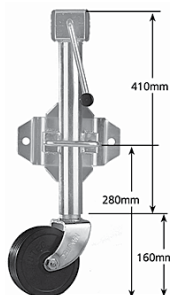

Comes with pin locking swivel bracket.  
Wheel: 150mm x 50mm  
Lift: 225mm  
Unit weight: 7.5kg  
Static load capacity: 500kg.

Side Winding Swivel Jockey Wheel - 6" Side Winding - 9075

**Solid Rubber Wheels**



Solid rubber replacement wheel.  
 6" Solid Rubber Wheel - 9068  
 8" Solid Rubber Wheel - 9069  
 10" Solid Rubber Wheel - 9070

**Heavy Duty Swivel Plate**



Weld-on heavy duty swivel plate. To suit heavy duty range of jockey wheels and stands using heavy duty 60mm OD outer tube.  
 Unit Weight: 3.3kg

Heavy Duty Swivel Plate - 9071

**Quick Release Adjustable Leg**



400mm - 9080  
 460mm - 9081  
 520mm - 9082  
 620mm - 9083

**Hex Head Handle - Suit Drill**



M Series Handle-Hex Head Type suitable for use with a power drill, Length-590mm, Unit Weight of 600 Grams.

Hex Head Handle - Suit Drill - 9085

**Jockey Wheel Clamp**



Fixed clamp. Bolt on or weld on.  
 Jockey Wheel Clamp - 9098

**Boat Clamp**

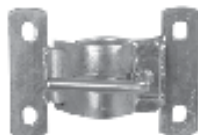

For fixing with 75mm U-bolts to suit standard and medium range of Jockey wheels and stands using standard 48mm OD outer tube.  
 Unit weight: 1.5kg

Boat Clamp - 9100



**Drop Down Corner Steady**



Made from galvanized steel Comes with mounting bracket and fitting Multi-Positional Twin Locking Pin Incorporate Big Foot Designed for easy access from side for van. Available in three sizes. 590mm, 740mm and 840mm.

590mm - 9110  
 740mm - 9112  
 840mm - 9113

**Heavy Duty Side Winding Swivel Jockey Wheel - 8"**

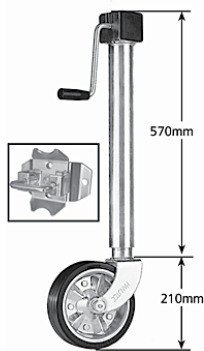

Comes with heavy duty pin locking swivel bracket. Wheel: 200mm x 55mm  
 Lift: 225mm Unit weight: 15.6kg Static load

Heavy Duty Side Winding Swivel Jockey Wheel - 8" - 9120

**Adjustable Stand**

Medium duty adjustable stand (side winding) with loose handle.  
 Outer Tube: 60 x 60 x 4mm  
 Inner Tube: 50 x 50 x 3mm  
 Lift: 350mm  
 Unit Weight: 12.2kg  
 Static Load Capacity: 1000kg

Height Closed 1050mm  
 Height Open 1400mm

Adjustable Stand - 9125

**Slotted Head Handle Suit Drill**



P Series Handle- Slotted Type suitable for use with a power drill, Length- 570mm, Unit Weight of 500 Grams.

Slotted Head Handle Suit Drill - 9127



**Jockey Wheel Handle**



Replacement Jockey Wheel Handle Universal Fit-Grub Screw -Suits Most Jockey Wheels and Split Pin also sold separately

Jockey Wheel Handle - 9130  
 Grub Screw - 9131  
 Split Pin - 9132

**Adjustable Locking Pin Swivel Bracket**



For ultimate choice (swivel the jockey wheel or remove it) and adjustment range. Will suit caravans and trailers with very high or low ground clearance.

Adjustable Locking Pin Swivel Bracket - 9135

**Jockey Wheel Handle**



Replacement Jockey Wheel Handle-Universal Fit-Split Pin -Suits Most Jockey Wheels up to 350kgs

Jockey Wheel Handle - 9136

**Heavy Duty Side Winding Swivel Jockey Wheel - 10"**

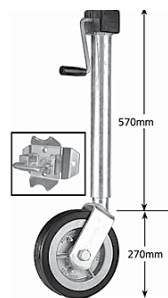

Comes with heavy duty pin locking swivel bracket. Wheel: 250mm x 50mm  
 Lift: 225mm Unit weight: 18kg  
 Static load capacity: 1250kg.

Heavy Duty Side Winding Swivel Jockey Wheel - 10" - 9140

**U Bolts**



Jockey Wheel U Bolt fitting. Comes as a pair with washers and bolts

50mm - 9152  
75mm - 9154  
100mm - 9156

**Plastic Jockey Wheel Receiver**



Protects your jockey wheel from sinking into the ground.

Plastic - 0578 Rubber - 0606

**Rubber Jockey Wheel Receiver**



Heavy duty rubber jockey wheel receiver.  
Rubber Jockey Wheel Receiver - 0606

**Adjustable Leg with Wheel**



Adjustable leg - weld-on Length: 500mm  
Rear: With wheel  
Type: Metric thread Hex-head handle fitment Unit Weight: 3.7kg

Adjustable Leg with Wheel - 9200

**Adjustable Leg**



Adjustable leg - weld-on Length: 500mm  
Front: No wheel  
Type: Metric thread Hex-head handle fitment Unit Weight: 3.6kg

Adjustable Leg - 9210

**XL Rubber Jockey Wheel Receiver**



Suitable for larger 8" & 10" pneumatic or solid jockey wheel tyres.

XL Rubber Jockey Wheel Receiver - 0605

**Disc Hubs**



1/2" Hub Includes, dustcaps, seals and nuts.

Holden HQ - 9220

Holden HT - 9222

Ford - 9224

5/8" Landcruiser - 9226

**Electric Brake Kits**



These 10" x 2&1/4" electric brake kits come complete with mounting flange, brake assembly, and hub drum including wheel studs, nuts, bearings and seals for two wheels.

LM Bearings - Holden - 9240

Composite bearings - Holden/Ford - 9245

Slimline bearings - Ford - 9250

**Adjustable Leg**



Adjustable leg - weld-on Length 500mm

Front: No wheel

Type: Power thread, slotted type handle fitment Unit weight: 3.4kg

Adjustable Leg - 9255

**Slotted Type Crank Handles**



Length - 900mm - 9260

Length - 550mm - 9265

**Hubs**



6" Hub, includes, dustcap, seals and nuts.

Holden HQ - 9270

Holden HT - 9272

Ford - 9276

7 1/2" Landcruiser - 9278

**Electric Brake Assemblies**



10" x 2&1/4" brake assemblies with park brake attachment.

Right hand - Off side - 9280

Left hand - Near side - 9287

**Brake Magnets**



Replacement electromagnets for the Kelsey Hayes oval and round brake assembly. Complete with spring and clip.

Oval - 9290

Round - 9295

**Adjustable Leg**



Adjustable leg - weld-on Length: 600mm

Front: No wheel

Type: Metric thread Hex-head handle fitment Unit Weight: 3.8kg

Adjustable Leg - 9300

**Hex-head Type Crank Handles**



Length 900mm - 9305

Length 590mm - 9310

**Hydraulic Brake**



9" x 1 3/4"

Right Hand - Off side - 9315  
Left Hand - Near side - 9320

**Hydraulic Brake Kit**

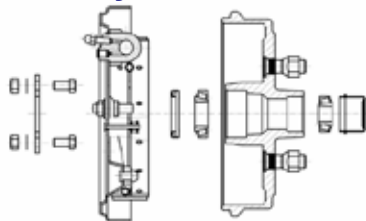

**SPECIFY WHEEL STUD PATTERN**

Each 9" x 1 3/4" hydraulic brake kit comes complete with hub drum and includes, wheel studs, nuts, bearings and seals, backing

LM bearings - Holden - 9335  
Composite bearings - Holden and Ford - 9340



**Trailer Bearings**

Kit consist of small and large bearings, water proof seal and split pin.  
150mm (6") nylon wheel.

Holden - suits 39mm - 40mm square trailer axle - 9350  
Ford slimline - Suits 45mm square trailer axle - 9360



**Marine Bearings**

Kit consist of small and large bearings, water proof seal and split pin.

Holden - suits 39mm - 40mm square trailer axle - 9402  
Ford slimline - Suits 45mm square trailer axle - 9406

**Bearing Buddies**



Constant lubricating bearing caps with spring loaded centre mechanism that continually supplies grease to the inner hub And bearings. Includes PVC dust cover. Sold as pairs

Bearing Buddies - 9433

**Bearing Caps**



Protect your bearings with this cap. Prevents dust and foreign bodies getting into your bearings  
Pair.

Bearing Caps - 9436

**Springs**

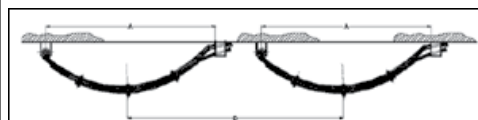

Slipper springs - 45mm x 6mm.

- 3 Leaf - 9450
- 4 Leaf - 9451
- 5 Leaf - 9452
- 6 Leaf - 9453
- 7 Leaf - 9454



**Axles**

Please specify length when ordering Axles

- 40mm Square 1000 kg LM - 9370
- 45mm Round 1200 kg Slimline - 9371
- 45mm Square 1450 kg Slimline - 9372
- 45mm Square 1500 kg 1.5 tonne - 9373
- 45mm Square 1600 kg Parallel - 9374
- 50mm Round 1450 kg Slimline - 9375
- 50mm Square 1450 kg Slimline - 9376
- 50mm Square 1500 kg 1.5 tonne - 9377

- 50mm Square 1600 kg Parallel - 9378
- 50mm Square 2000 kg 2.0 tonne - 9379
- 56mm Round 2000 kg 2.0 tonne - 9380
- 60mm Round (tube) 1400 kg Slimline - 9381
- 63mm Square 3000 kg 3.0 tonne - 9382
- 65mm Round 2500 kg 2.0 tonne - 9383
- 75mm Round 3500 kg 3.0 tonne - 9384

**Low Profile Steel Step**



Low profile, steel tread plate. 455mm wide, 60mm fixing frame

Low Profile Steel Step - 9400

**Single Treadplate Steel Step**



Steel treadplate. 500mm wide with 165mm mounting frame.

Single Treadplate Steel Step - 9410

**Double Treadplate Steel Step**



Double steel tread plate. 155mm wide

Double Treadplate Steel Step - 9460

**Single Aluminium Step**

*Available in Manual & 12V*



Weight: 4.8kg  
Capacity: 200kg  
Step Width: 540mm  
Drop Height: 150mm or 210mm  
Rated to 200kg. Easy to open, with spring loaded hinges. Corners are glow in the dark for assistance in darkness

Single - Manual - 9470  
Single - 12Volt - 9472

**Dual Aluminium Manual Step**



Weight: 7.7kg  
Capacity: 200kg  
Step Width: 540mm  
Drop Height: 30mm  
Rated to 200kg. Easy to open, with spring loaded hinges. Corners are glow in the dark for assistance in darkness.

Manual 12volt -9473

## Thule Ladders

### 6 Step Single Ladder

Anodised Aluminium  
Stainless Steel Fastening  
Components  
Extremely Light  
For Indoor or Outdoor Use  
30.5cm wide and 145cm tall  
Mounting brackets are  
14.5cm deep



6 Step Single Ladder - 9415

### 5 Step Single Ladder

Anodised Aluminium construction  
Stainless Steel Fastening Components.  
Extremely Light  
Internal use ladder with 5  
steps 30cm wide, 175cm tall,  
23cm between rungs, 33cm  
from the bottom to the first  
rung



5 Step Single Ladder - 9425

### 10 Step Double Ladder

Anodised Aluminium  
Stainless Steel Fastening  
Components  
Extremely Light  
For Indoor or Outdoor Use  
36cm wide  
345cm tall when open and  
125cm tall when closed  
46cm from the top of the  
ladder to top mounting  
bracket and 77cm down  
to the bottom mounting  
bracket



The folding section has a  
support arm to keep the  
ladder steady against the  
vehicle when in use  
Unit is 29cm deep when  
closed, including the  
mounting brackets

10Step Double Ladder - 9430

## 3.2m Telescopic Ladder



Meets AUS/NZ  
Standards

### WITH FINGER PROTECTION

Extension Length 3.2m  
Open Size(cm) 320x47x8  
Folded Size(cm) 80x47x8  
Step Height 30cm  
150kg Weight Rating  
9.8KG

Telescopic Ladder - 0106

## Lockable Jerry Can Holder



Painted black lockable jerry can holder.

Top Load  
355mm (w) x  
180mm (d) x  
477mm (h)

Jerry Can Holder - 9520

## Front Entry Jerry Can Holder



Front entry  
feature allows  
access where top  
loading is not  
possible. Carries &  
secures jerry  
cans up to  
355mm (w) x  
195mm (d) x  
510mm (h)



1  
Remove padlock  
and adjustable strap.  
Raise anti-theft bar.



2  
Tilt jerry can forwards,  
place in base first,  
then lean back.



3  
Lower anti-theft bar,  
lock padlock and secure  
adjustable strap.

Front Entry Jerry Can Holder - 9522

## Galvanized Jerry Can Holder Weld On



This welded steel bracket  
holds a 20 litre jerry can securely.

Galvanized Jerry Can Holder Weld On - 9475

## Quick Release Jerry Can Holder - Weld On



The first of its kind  
to Australia! Fully  
galvanized, the new  
quick release jerry  
can holder will make  
putting in and taking  
out your jerry can a  
breeze.

Quick Release Jerry Can  
Holder - Weld On - 9480

## Jerry Can Holder - Bolt On



GALVANISED  
370mm x 180mm x 300mm  
HEAVY DUTY

Jerry Can Holder - Bolt On - 9482

## Jerry Can Holder - Lockable



Jerry Can Holder  
Chain Lockable

Jerry Can Holder - Lockable - 9484

**20 Ltr Diesel Jerry Can**



Comes with flexible pourer.

20 Ltr Diesel Jerry Can - 0955

**20 Ltr Water Jerry Can**



Plastic 20 litre jerry can for water.

20 Ltr Water Jerry Can - 0958

**10 Ltr Water Jerry Can**



10 Ltr Water Jerry Can - 0961

**Jerry Pourer**



Flexible pourer fits most metal jerry cans

Jerry Pourer - 9490

**20 Ltr Fuel Jerry**



Metal 20 litre jerry can.

20 Ltr Fuel Jerry - 9503

**20 Ltr Fuel Jerry Can**



Comes with flexible pourer

20 Ltr Fuel Jerry Can - 0952

**20 Ltr Water Jerry Can**



Plastic clear 20 litre jerry can for water.

20 Ltr Water Jerry Can - 9506

**Cube Water Jerry Cans**



Plastic jerry can for water. Available in 15l, 20l and 25l.

15 Litre Water Jerry Can -9535

25 Litre Water Jerry Can - 9537

**Weld On Spare Wheel Mount**



The BOLT-ON spare wheel mount comes complete with 2 U-bolts and nuts to allow temporary fixing to the caravan A-frame. The wheel is held securely on the mount by a retaining disc and can be padlocked to prevent theft.

Weld On Spare Wheel Mount - 9515

**Bolt on Spare Wheel Mount**



Made from 65 x 35 x 3mm RHS steel, this straight version can be welded direct to the caravan A-frame or bumper bar. The retaining disc keeps the spare wheel secure. There is provision for padlocking.

Bolt on Spare Wheel Mount - 9550

**Spare Wheel Carrier - Holden**



To suit Holden wheel with H.T. Stud (7/16" Stud) Suits 50mm Ubolt.

Spare Wheel Carrier - Holden -9552

**Spare Wheel Carrier - Ford**



To suit Ford Wheel stud (1/2" Stud) Suits 50mm Ubolt.

Spare Wheel Carrier - Ford - 9554

**"OzHitch" Off Road Hitch**



Tough 3.5 tonne rated Lockable pin for security - bolt on, weld on

"OzHitch" Off Road Hitch - 9600



**2000kg Override Coupling**



**2000kg Coupling - 9610**

**2 Hole Trailer Coupling**



With a quick release mechanism. Two fixing holes. Rated to 1000kg

**2 Hole Trailer Coupling - 9602**

**3 Hole Trailer Coupling**



With a quick release mechanism. Three fixing holes. Rated to 1000kg

**3 Hole Trailer Coupling - 9605**

**HITCHMASTER® DO35 V2-1**



The redesigned HITCHMASTER® DO35 trailer coupling now features an integrated handbrake. DO35 V2-1 -9606

**Polly Block Coupling**



“OFF ROAD POLY-BLOCK COUPLING “ Coupling is rated at 2.0T (2000KG) Includes clamp

**Polly Block Coupling - 9615**

**Polly Block Clamp**



**Polly Block Clamp - 9618**

**Spare Wheel Holder**



**Spare Wheel Holder - 9620**

**Break-Away Kit**



Breakaway switches are required on vehicles over 2000kgs

Breakaway Kit includes ·Plastic easy mount case ·Breakaway Switch . LED test button

**Complete Kit - 9630  
Battery - 9631**

**Break-Away Switch with Coiled Cable**



The Breaksafe breakaway switch now comes with the new Coil Cable and stainless steel quick release clip for easy connection to the tow vehicle.

**Break-Away Switch with Coiled Cable - 9635**

**4ft Breakaway Cable**



Pull on brakes in case of outfit detachment Suitable for direct attachment Designed for direct attachment where designated towball mounting point exists.

**4ft Breakaway Cable - 9636**

**Break-Away Switch with Cable**



The breakaway switch is designed to operate electric brakes for a period of 15 minutes in cases where the trailer has detached for the vehicle when travelling. Includes 4ft of cable.

**Breakaway switch with cable - 9637**

**Coiled Breakaway Cable**



No more excess cable to be tied up or looped around. Less chance of the cord getting snagged on road debris.

**Coiled Breakaway Cable - 9638**

**DO35 Tow Pin - Shank 7/8”**



Get a spare DO35 Tow Pin for your second vehicle. SA5 plated and rated to tow 3.5T off-road.

**Coiled Breakaway Cable - 9639**

**DO35 BiLock Assembly**



The HITCHMASTER® Bi-Lock assembly consists of a dummy pin, two keys, a lock and a dust cover.

**DO35 BiLock Assembly - 9640**

